

1

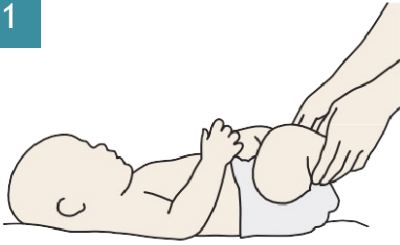

- You will need:
 1. These instructions,
 2. Your nappy swab kit,
 3. A pen
- Change your baby's dirty nappy
- Put the dirty nappy to one side until your baby is back in a safe position (e.g. crib)

2

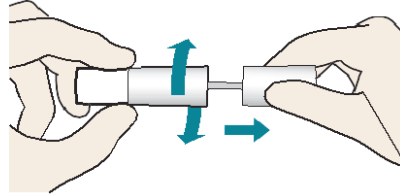

- Open the dirty nappy on a firm surface
- Twist and pull the tube to open, so the swab tip is free
- Be careful to not touch the swab tip on your skin or any other surface

3

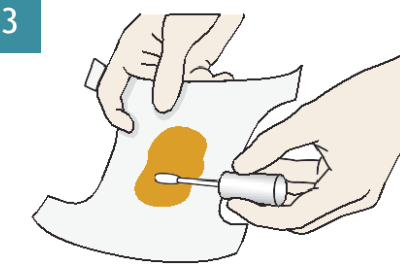

- Lightly touch the swab tip to pick up a small smear of poo from the dirty nappy

4

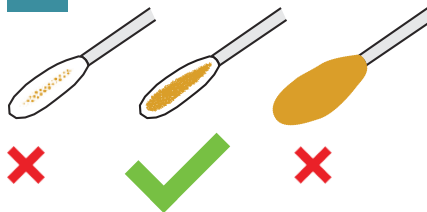

- Don't take too much poo
- The swab tip only needs to be coloured a bit

5

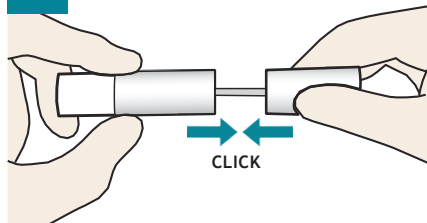

- Put the swab straight back into the tube
- Don't let the swab tip touch your skin or any other surface
- Click the tube firmly shut

6

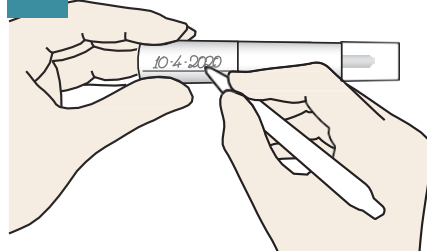

- Write the date on the tube, where it says 'Date collected'

7

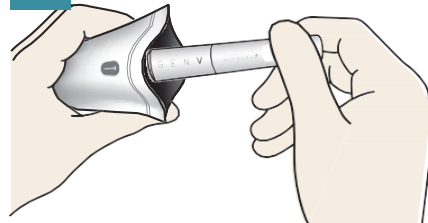

- Put the tube into the white pouch
- Press the pouch edges together to seal, with as little air as possible

8



- Put the white pouch into the reply-paid envelope
- Seal the envelope
- It can stay at room temperature (not in the fridge or freezer)

9



- Post the envelope to GenV within a week, or as soon as possible – put it into any Australia Post box, no stamp needed

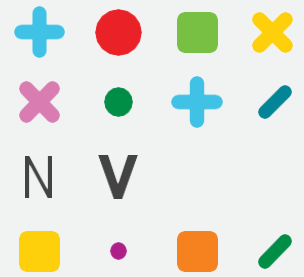

We believe that childhood health problems can be solved.

GenV Nappy Swab Instructions

Collecting your baby's poo sample

- before you start

- Please read these instructions
- Baby less than a week old?** Collect sample at age 7 days, or as soon as you can after that
- Baby is more than a week old?** Collect sample as soon as you can
- Forgot or hard to collect?** Return your sample at any time - every sample is important

- Lost the kit or made a mistake? - contact us:

Phone: 1800 436 888 Website: www.genv.org.au

V2.0 2022-05-20



Thank you for helping to make the next generation the healthiest ever.